

WILPINJONG COAL PROJECT CULTURAL HERITAGE CLEARANCE FORM

NUMBER

038

In accordance with the Aboriginal Cultural Heritage Management Plan, the known sites listed below and within the defined area shown on the attached map have been salvaged.

ALL SECTIONS OF THIS FORM **MUST BE FILLED IN**. (N/A to be used when applicable).
A MAP OF THE SALVAGED AREA **MUST BE INCLUDED AS ATTACHMENT 1**

Section 1: Archaeologist Details

Company:	Kayandel Archaeological Services		
Archaeologist:	Lance Syme		20/02/2013
	Name	Signature	Date

Section 2: Salvage Details

Type of Cultural Heritage Salvage Completed:	<input type="checkbox"/> Scar Tree Removal (Go to Section 3)
	<input checked="" type="checkbox"/> Surface Salvage (Go to Section 4)
	<input type="checkbox"/> Sub-surface Salvage (Go to Section 4)

Section 3: Scar Tree Details

	Yes	No	Name	Signature	Date
Scar Tree Photographed	<input type="checkbox"/>	<input type="checkbox"/>			
Scar Tree Removed	<input type="checkbox"/>	<input type="checkbox"/>			
Scar Tree Labelled	<input type="checkbox"/>	<input type="checkbox"/>			
Stored In Keeping Place	<input type="checkbox"/>	<input type="checkbox"/>			
AHIMS Database Updated	<input type="checkbox"/>	<input type="checkbox"/>			
Removed Delineation	<input type="checkbox"/>	<input type="checkbox"/>			
Notes					

Section 4: Details of Sites Salvaged

WCP EIS Site Number	AHIMS Site Number	Projection	Zone	Easting	Northing
NIL					

AHIMS Database Updated	<input type="checkbox"/> Yes	<input type="checkbox"/> No	Date:	
Name:			Signature:	

Placement of Artefacts:	Location	Name	Signature	Date
<input type="checkbox"/> Archaeologist Company Site				
<input type="checkbox"/> Wilpinjong Keeping Place				
<input type="checkbox"/> Other				

Section 5: Details of Area Salvaged

Corner (e.g. NNE)	Projection	Zone	Easting	Northing
SW	GDA94	55	771024	6416814
NW	GDA94	55	770991	6416871
N	GDA94	55	771667	6417037
NE	GDA94	55	771730	6417052
SE	GDA94	55	771769	6416997

Wilpinjong Coal Database Updated	<input type="checkbox"/> Yes	<input type="checkbox"/> No	Date:	
Name:			Signature:	

ATTACHMENT 1
MAP OF SALVAGED AREA

20130220

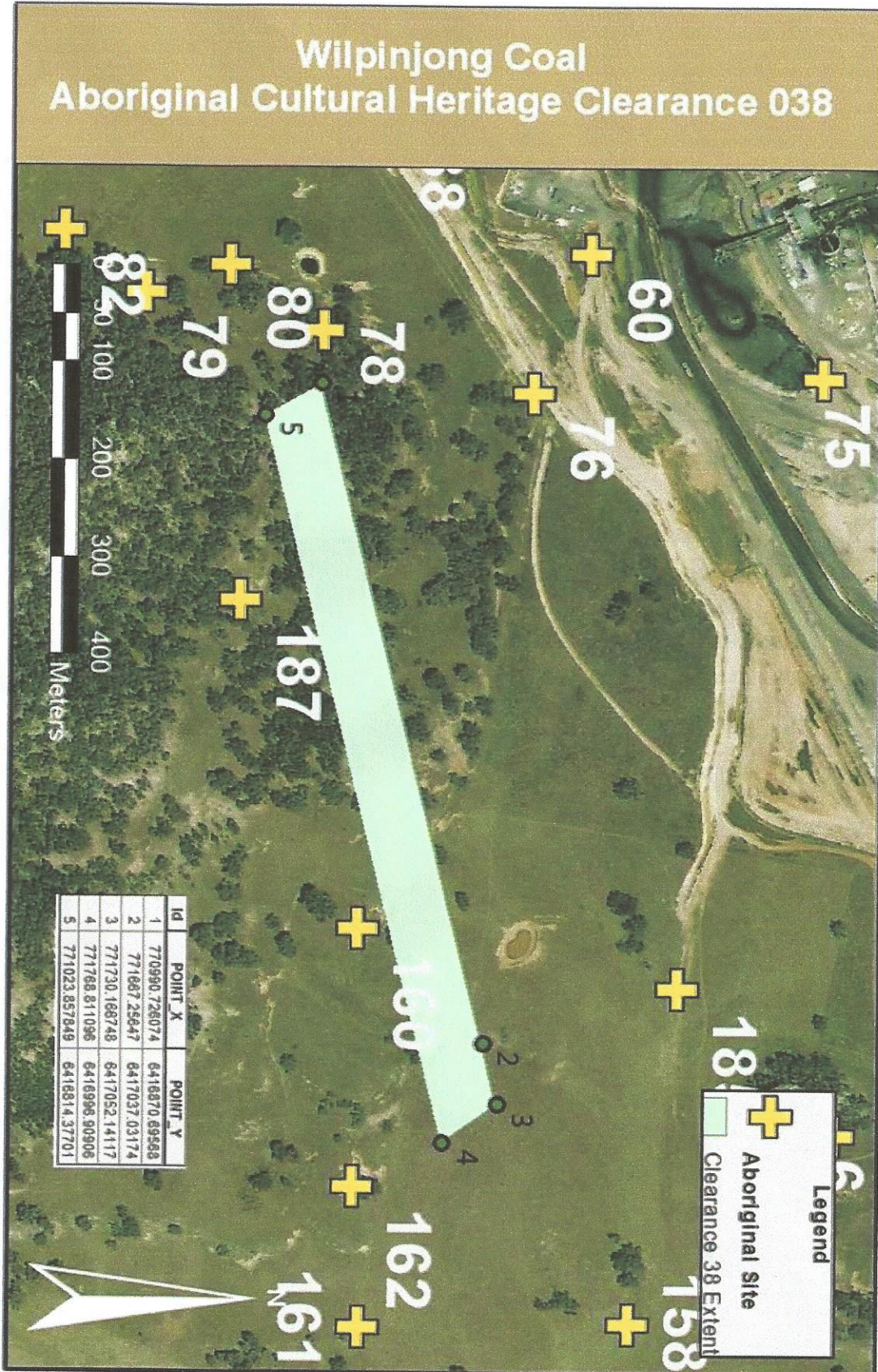

Section 6: Attending Aboriginal Representative(s) Details

We confirm that we participated in the survey undertaken on
for the area described above and shown in Attachment 1.

Group: Warrabinga	Name: Kekey Williams-Mack	Signature: Williams	Date: 24.2.13
Group:	Name: (Director)	Signature:	Date:
Group: New Co	Name: L. Syme	Signature: Syme	Date: 27/2/13
Group:	Name:	Signature:	Date:
Group:	Name:	Signature:	Date:
Group:	Name:	Signature:	Date:
Group:	Name:	Signature:	Date: