

WILPINJONG COAL PROJECT CULTURAL HERITAGE CLEARANCE FORM

NUMBER
037

In accordance with the Aboriginal Cultural Heritage Management Plan, the known sites listed below and within the defined area shown on the attached map have been salvaged.

ALL SECTIONS OF THIS FORM **MUST BE FILLED IN**. (N/A to be used when applicable).
A MAP OF THE SALVAGED AREA **MUST BE INCLUDED AS ATTACHMENT 1**

Section 1: Archaeologist Details

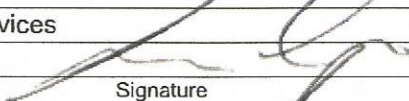
Company:	Kayandel Archaeological Services		
Archaeologist:	Lance Syme	 Signature	20/02/2013 Date
	Name		

Section 2: Salvage Details

Type of Cultural Heritage Salvage Completed:	<input type="checkbox"/> Scar Tree Removal (Go to Section 3) <input checked="" type="checkbox"/> Surface Salvage (Go to Section 4) <input type="checkbox"/> Sub-surface Salvage (Go to Section 4)
---	---

Section 3: Scar Tree Details

				Name	Signature	Date
Scar Tree Photographed	<input type="checkbox"/> Yes	<input type="checkbox"/> No				
Scar Tree Removed	<input type="checkbox"/> Yes	<input type="checkbox"/> No				
Scar Tree Labelled	<input type="checkbox"/> Yes	<input type="checkbox"/> No				
Stored In Keeping Place	<input type="checkbox"/> Yes	<input type="checkbox"/> No				
AHIMS Database Updated	<input type="checkbox"/> Yes	<input type="checkbox"/> No				
Removed Delineation	<input type="checkbox"/> Yes	<input type="checkbox"/> No				
Notes						

Section 4: Details of Sites Salvaged

WCP EIS Site Number	AHIMS Site Number	Projection	Zone	Easting	Northing
NIL					

AHIMS Database Updated	<input type="checkbox"/> Yes	<input type="checkbox"/> No	Date:	
Name:			Signature:	

Placement of Artefacts:	Location	Name	Signature	Date
<input type="checkbox"/> Archaeologist Company Site				
<input type="checkbox"/> Wilpinjong Keeping Place				
<input type="checkbox"/> Other				

Section 5: Details of Area Salvaged

Corner (e.g. NNE)	Projection	Zone	Easting	Northing
SW	GDA94	55	772966	6418497
NW	GDA94	55	772999	6418593
NE	GDA94	55	773144	6418629
SE	GDA94	55	773056	6418289

Wilpinjong Coal Database Updated	<input type="checkbox"/> Yes	<input type="checkbox"/> No	Date:	
Name:			Signature:	

ATTACHMENT 1
MAP OF SALVAGED AREA

20130220

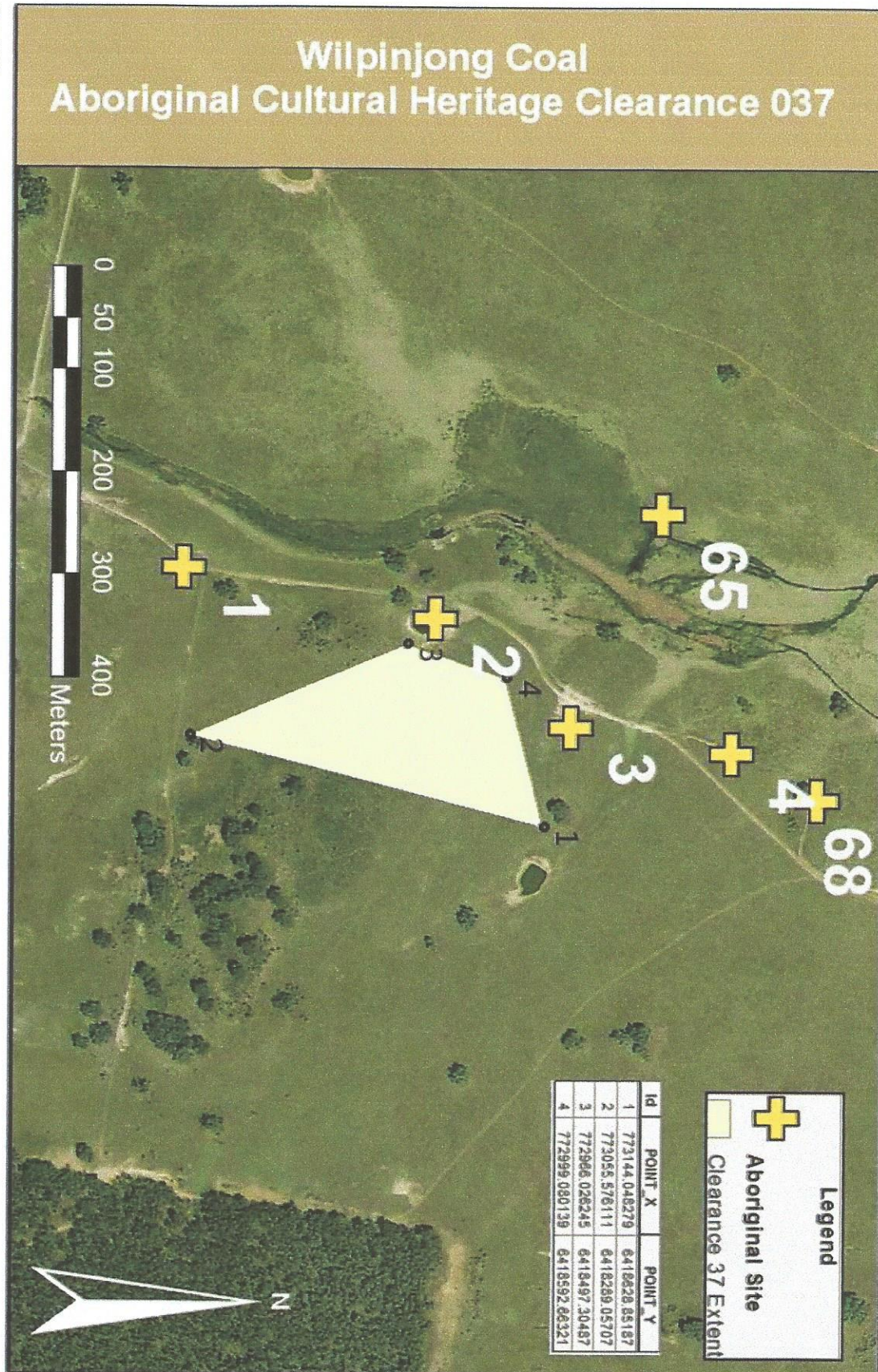

Section 6: Attending Aboriginal Representative(s) Details

We confirm that we participated in the survey undertaken on
for the area described above and shown in Attachment 1.

Group: Werrabingpa	Name: Kelsey W-F	Signature: K. Williams	Date: 24.2.13.
Group:	Name: (Director)	Signature:	Date:
Group: Newco	Name: L. Syme	Signature: L. Syme	Date: 27/2/13
Group:	Name:	Signature:	Date:
Group:	Name:	Signature:	Date:
Group:	Name:	Signature:	Date:
Group:	Name:	Signature:	Date:
Group:	Name:	Signature:	Date: